

# SUBMITTAL/TECHNICAL DATA SHEET



## ADVANTAGES

- MATERIAL:**
- U-LP : 14 gauge galvanized steel cover and 14 gauge galvanized steel curb with a 12 gauge galvanized steel curb cap
  - U-LPA : .10 Aluminum cover and .10 Aluminum curb with .125 Aluminum curb cap
  - U-LPAG : .10 Aluminum cover and 14 gauge galvanized steel curb with 12 gauge galvanized steel curb cap

- FINISH:**
- Galvanized Steel: Mill Finish
  - Aluminum: Mill Finish

**COVER:** High-strength composite construction with exterior cover and liner bonded to a 2" core of rigid foam-type insulation

**CURB:** 1 1/2" in height with 3 1/2" pre-drilled mounting flanges and counterflashing with 1" thick exterior fiberboard insulation

**GASKET:** Polyurethane Foam Gasket adhered to the entire perimeter of curb

**HINGES:** Steel Pintle Hinge

**SPRINGS:** Dampened Gas Springs to open against 10 psf snow or wind load at a safe controlled speed

**LATCHES:** Latch designed to open automatically with parting of single 165 degree fusible link or manually with interior and exterior pull release handles without disturbing the fusible link. Designed to withstand 90 psf wind uplift for class 90 roof decks.

**HARDWARE:** All hardware is zinc plated (stainless steel hardware optional)

**LOAD CAPACITY:** 50psf

**OPERATION:** Covers automatically spring open to approximately 90 degrees in the event of fire, being actuated by the parting of a single UL-listed 165 degree F fusible link, automatically locking in the fully opened position

- CERTIFICATIONS:**
- UL 793 Listed
  - UL 790 Certified

Heat & Smoke Vents Protect in the Event of Smoke & Fire: Opens instantly when UL listed fusible link is exposed to a temperature of 165 degrees to release noxious smoke and deadly gases out of the building.

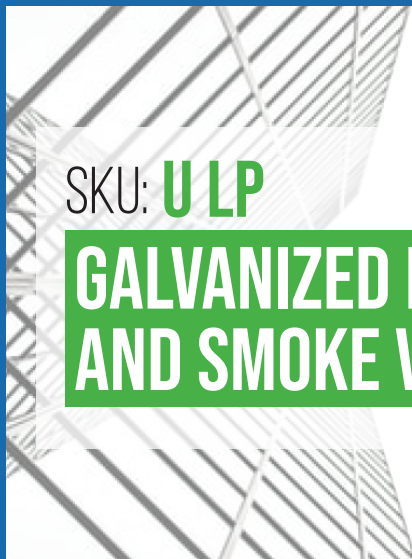

## DIMENSIONS AND APPEARANCE

>> CLICK TO VIEW ADDITIONAL DETAILS AND PRICING <<

### STANDARD SIZES AND PRODUCT NUMBERS:

DOOR SIZE	MATERIALS	MODEL	SHIPPING WEIGHT LBS.
4'0" x 4'0"	Galvanized Steel	U-LP-4848	260
4'0" x 5'0"	Galvanized Steel	U-LP-4860	310
4'0" x 6'0"	Galvanized Steel	U-LP-4872	360
4'0" x 7'0"	Galvanized Steel	U-LP-4884	410
4'0" x 7'6"	Galvanized Steel	U-LP-4890	435
4'0" x 8'0"	Galvanized Steel	U-LP-4896	460
4'6" x 4'0"	Galvanized Steel	U-LP-5448	285
4'6" x 5'0"	Galvanized Steel	U-LP-5460	345
4'6" x 6'0"	Galvanized Steel	U-LP-5472	405
5'0" x 5'0"	Galvanized Steel	U-LP-6060	370
5'0" x 6'0"	Galvanized Steel	U-LP-6072	421
5'0" x 7'0"	Galvanized Steel	U-LP-6084	491
5'0" x 8'0"	Galvanized Steel	U-LP-6096	551
5'0" x 9'0"	Galvanized Steel	U-LP-60108	611
5'6" x 6'0"	Galvanized Steel	U-LP-6672	461
5'6" x 7'0"	Galvanized Steel	U-LP-6684	531
5'6" x 8'0"	Galvanized Steel	U-LP-6696	640
5'6" x 9'0"	Galvanized Steel	U-LP-66108	695
6'0" x 6'0"	Galvanized Steel	U-LP-7272	502
6'0" x 7'0"	Galvanized Steel	U-LP-7284	586
6'0" x 8'0"	Galvanized Steel	U-LP-7296	686
6'0" x 9'0"	Galvanized Steel	U-LP-72108	756

Check the Second Page for more Detailed Information

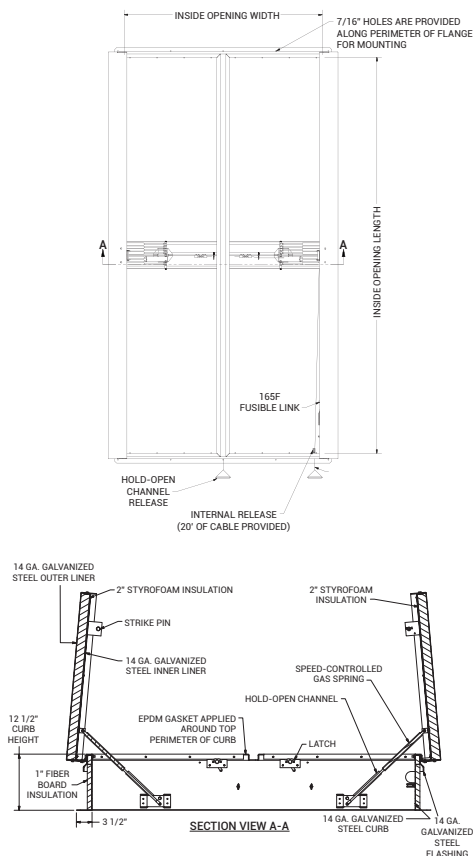

For a complete list of options visit [www.AccessDoorsAndPanels.com](http://www.AccessDoorsAndPanels.com)

## PROJECT DATA

Custom Sizes Available - Fast!

Scan or Click



To view Pricing and Additional Product Info.

PROJECT NAME :	QTY	W	H	OPTIONS
ARCHITECT :				
DEALER :				
CONTRACTOR :				
LOCATION :	SPECIAL INSTRUCTIONS :			
DATE :	SUBMITTAL APPROVAL : (signature or stamp)			
TAGGING INSTRUCTIONS :				

TELEPHONE:  
1-888-457-1275  
FAX:  
1-888-626-2907



PO BOX 66738 #76520,  
SAINT LOUIS, MO  
63166-6738  
USA



WEBSITE:  
[www.AccessDoorsAndPanels.com](http://www.AccessDoorsAndPanels.com)  
E-MAIL:  
[info@accessdoorsandpanels.com](mailto:info@accessdoorsandpanels.com)



# ULP

# BIG SMOKY UL VENTS

STANDARD MODEL TABLE:

MODEL	WIDTH, IN	LENGTH, IN	MODEL	WIDTH, IN	LENGTH, IN
ULP-4848	48	48	ULP-60144	60	144
ULP-4860	48	60	ULP-6672	66	72
ULP-4872	48	72	ULP-6684	66	84
ULP-4884	48	84	ULP-6696	66	96
ULP-4890	48	90	ULP-66108	66	108
ULP-4896	48	96	ULP-66120	66	120
ULP-5448	54	48	ULP-66132	66	132
ULP-5460	54	60	ULP-66144	66	144
ULP-5472	54	72	ULP-7272	72	72
ULP-6060	60	60	ULP-7284	72	84
ULP-6072	60	72	ULP-7296	72	96
ULP-6084	60	84	ULP-72108	72	108
ULP-6096	60	96	ULP-72120	72	120
ULP-60108	60	108	ULP-72132	72	132
ULP-60120	60	120	ULP-72144	72	144
ULP-60132	60	132	-	-	-

